



STAINLESS STEEL

REGALINE SINKS

One & Two Compartments without Drainboards



93 & 9 SERIES
Welded Side
Cross-Bracing



94 SERIES
Welded Side & Adjustable
Front & Rear Cross-Bracing

Item #: _____ Qty #: _____

Model #: _____

Project #: _____



Recessed Bowl Surface
Accommodates
Poly-Vance Cutting Boards
& Sink Covers



FEATURES:

Tile edge for ease of installation.

One piece **Deep Drawn** sink bowls with splash.

All sink bowls have a large liberal 3" radius.

Placement of the welded leg assembly ensures stability and furnishes direct support of the column load requirement for the entire sink unit.

"94" Series are supplied with adjustable front and rear cross brace featuring leg casting to secure left to right cross bracing.

CONSTRUCTION:

All TIG welded.

Welded areas blended to match adjacent surfaces and to a satin finish.

Gussets welded to a die-embossed reinforcing channel.

MATERIALS:

Spec-Line (94 Series): 14 gauge type 304 stainless steel
11" High Splash.

Standard (93 Series): 16 gauge type 304 stainless steel
8" High Splash.

Super Saver (9 Series): 18 gauge type 304 stainless steel
8" High Splash.

- LEGS:**
- 1 5/8" diameter tubular stainless steel.
 - Stainless steel gussets & channels.
 - Stainless Steel 1" adjustable bullet feet.

YES! It's SeaLess!

		SPEC-LINE 94 Series		STANDARD 93 Series		SUPER SAVER 9 Series		Cu.	
Bowl Size	O.A. Length	# of Comp.	Model #	WT.	Model #	WT.	Model #	Ft.	
			14 Ga. 304 S/S 14" Water Level		16 Ga. 304 S/S 12" Water Level		18 Ga. 304 S/S 12" Water Level		
16" x 20"	25"	One	94-1-24	77 lbs.	93-1-24	62 lbs.	9-1-24	54 lbs.	20
	44"	Two	94-2-36	109 lbs.	93-2-36	76 lbs.	9-2-36	66 lbs.	20
20" x 20"	29"	One	94-21-20	92 lbs.	93-21-20	80 lbs.	9-21-20	61 lbs.	20
	52"	Two	94-22-40	116 lbs.	93-22-40	92 lbs.	9-22-40	79 lbs.	23
18" x 24"	27"	One	94-61-18	95 lbs.	93-61-18	84 lbs.	9-61-18	78 lbs.	44
	48"	Two	94-62-36	165 lbs.	93-62-36	144 lbs.	9-62-36	132 lbs.	56
24" x 24"	33"	One	94-41-24	97 lbs.	93-41-24	85 lbs.	9-41-24	72 lbs.	23
	60"	Two	94-42-48	174 lbs.	93-42-48	145 lbs.	9-42-48	133 lbs.	31
20" x 28"	29"	One	94-81-20	134 lbs.	93-81-20	94 lbs.	9-81-20	82 lbs.	27
	52"	Two	94-82-40	176 lbs.	93-82-40	150 lbs.	9-82-40	138 lbs.	45
			14" Water Level 17" Flood Level		12" Water Level 15" Flood Level		12" Water Level 15" Flood Level		



Customer Service Available To Assist You **1-800-645-3166** 8:30 am - 8:00 pm E.S.T.

For Orders & Customer Service:

Email: customer@advancetabco.com or Fax: 631-242-6900

For Smart Fabrication™ Quotes:

Email: smartfab@advancetabco.com or Fax: 631-586-2933

DIMENSIONS and SPECIFICATIONS

TOL Overall: $\pm .500''$
Interior: $\pm .250''$

ALL DIMENSIONS ARE TYPICAL

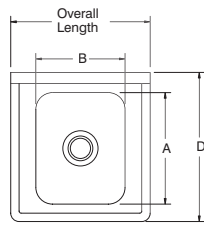

1 Compartment

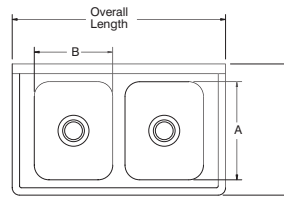
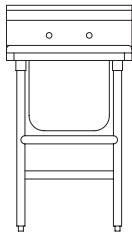

2 Compartment

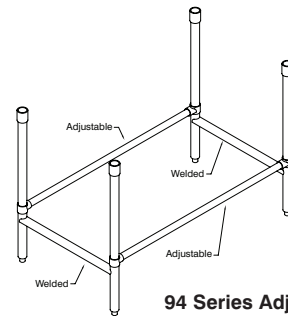
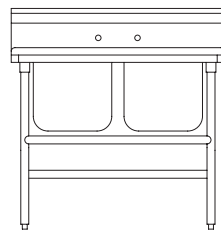

94 Series Adjustable Cross Bracing

DESCRIPTION

BOWL (SIZE)	# of Compart.	Overall Length	Recommended Use	A	B	C	D	94 SERIES					9 & 93 SERIES				
								V	W	X	Y	Z	V	W	X	Y	Z
16x20	One	25"	DISH SINKS	20"	16"	13 5/8"	27"	38"	11"	14"	20"	45"	38"	8"	12"	22"	42"
	Two	44"															
20x20	One	29"	DISH & POT SINKS	20"	20"	13 5/8"	27"	38"	11"	14"	20"	45"	38"	8"	12"	22"	42"
	Two	52"															
18x24	One	27"	POT & PAN SINKS	24"	18"	15 5/8"	31"	38"	11"	14"	20"	45"	38"	8"	12"	22"	42"
	Two	48"															
24x24	One	33"	POT SINKS	24"	24"	15 5/8"	31"	38"	11"	14"	20"	45"	38"	8"	12"	22"	42"
	Two	60"															
20x28	One	29"	PAN SINKS	28"	20"	17 5/8"	35"	38"	11"	14"	20"	45"	38"	8"	12"	22"	42"
	Two	52"															

Regalines with 36" Drainboards are Supplied with Two Additional Legs (per drainboard) for Support.

PLUMBING ROUGH-IN

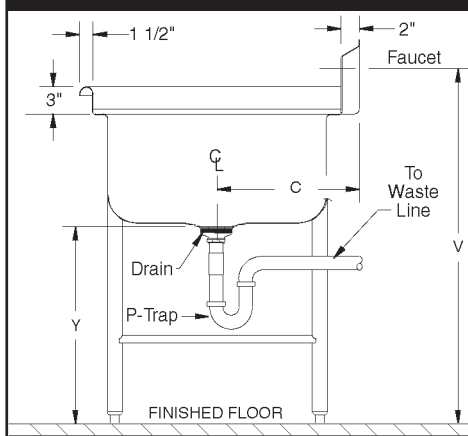

MECHANICAL:

- Supply is 1/2" IPS hot & cold.
- Faucet holes on 8" centers.
- Faucets are not included (see accessories).
- Waste drains are 1 1/2" IPS S/S basket type, located in center of sink bowl, and are included.



SECTION

