



STAINLESS STEEL

SINGLE DOOR MOP SINK CABINET



Item #: _____ Qty #: _____

Model #: _____

Project #: _____



Cabinet Includes
Floor Mop Sink

FEATURES:

16" x 20" x 12" Sink Bowl with Drain
Slotted Side Panels for Ventilation
Single Left-Hinged Door
Fixed Stainless Steel Utility Shelf
2 Mop Holders (1 on each side)

CONSTRUCTION:

All TIG welded.
Welded areas blended to match adjacent surfaces
and to a satin finish.

MATERIAL:

16 gauge type "304" Series Sink Bowl
18 gauge type "304" Series Sink Bowl Apron
9-OPC-84 - 18 gauge type "430" Series Stainless Steel Cabinet
9-OPC-84-300 - 18 gauge type "300" Series Stainless Steel Cabinet

OPTIONS:

TA-46 Door Lock
K-94-SHELF Fixed Mid-shelf for 84" High Cabinets
K-94-BACK Add 430 Stainless Steel Back Panel
K-94-BACK-300 Add 300 Stainless Steel Back Panel
K-472 Add 8" O.C. Faucet Holes for Service Faucet
(Must provide faucet hole height location)
K-240 Service Faucet
CAB-R Modify Unit to a Right-Hand Door Swing
Standard Left-Hand Door Swing (If required,
specify optional right-hand door swing when ordered)



Model #	Cabinet Material
9-OPC-84	18 Ga., 430 S/S
9-OPC-84-300	18 Ga., 300 S/S



Customer Service Available To Assist You **1-800-645-3166** 8:30 am - 8:00 pm E.S.T.

For Orders & Customer Service:

Email: customer@advancetabco.com or Fax: 631-242-6900

For Smart Fabrication™ Quotes:

Email: smartfab@advancetabco.com or Fax: 631-586-2933

REF-E

DIMENSIONS and SPECIFICATIONS

ALL DIMENSIONS ARE TYPICAL

TOL ± .500"

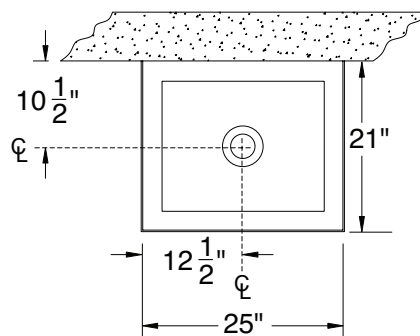
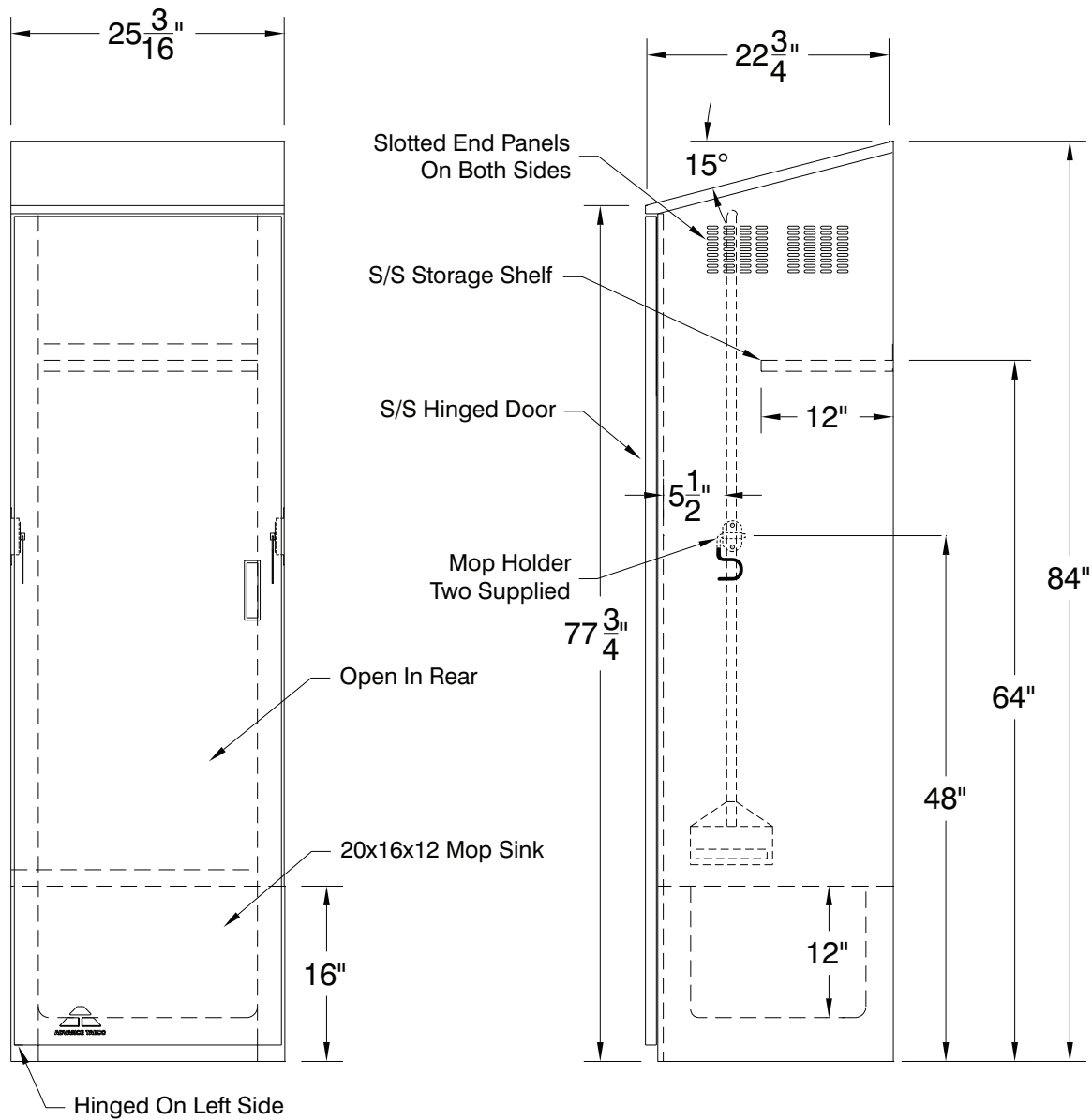

Mop Sink Detail

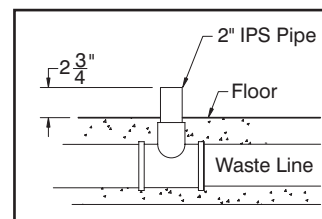

Drain Detail

250 lbs.



REF-E

200 Heartland Boulevard, Edgewood, NY 11717-8380

ADVANCE TABCO is constantly engaged in a program of improving our products. Therefore, we reserve the right to change specifications without prior notice.

© ADVANCE TABCO, JANUARY 2019