



a Standex company

ITEM: _____ PROJECT NAME: _____ DATE: _____

CHOCOLATE & CONFECTIONERY CASE CLIMATE CONTROLLED NON-REFRIGERATED

MODEL ☐ FCCR-4

☐ FCCR-5

☐ FCCR-6

MODEL ☐ FCC-4

☐ FCC-5

☐ FCC-6



*Blend elegant styling, superb merchandising flexibility, and craftsmanship to maximize profits.
Cases are available in lengths of 4', 5', and 6'. Designed for continuous case line-ups.*

STANDARD FEATURES

- Hinged, curved front safety glass tilts back for easy cleaning.
 - Reflective rear sliding service doors with lock.
 - Mirrored interior ends.
 - Three tiers of adjustable tempered glass shelves.
 - LED top and individual shelf lights. Lights are independently wired.
 - All welded base construction with laminated exterior.
 - Gold trim standard. Silver trim optional.
 - Removable sliding rear doors, shelf lights, shelf supports, and shelves.
 - Rear storage area with lock.
 - Easily accessible control panel.
 - White display deck.
- Added features for climate-controlled case.**
- Condensate evaporator provided for a totally self-contained system.
 - Customer adjustable temperature and humidity controls balance case environment to prevent discoloration, dehydration, and loss of gloss.
 - Climate-controlled rear storage area with lock.
- Added features for non-refrigerated cases.**
- Vent system to reduce heat build-up from the lights.

CHOCOLATE & CONFECTIONERY CASE

OPTIONAL ACCESSORIES:

- ☐ Special Exterior Finishes
- ☐ Top Rear Wrapping Board
- ☐ Silver Trim
- ☐ Casters or Legs
- ☐ Cord and Plug

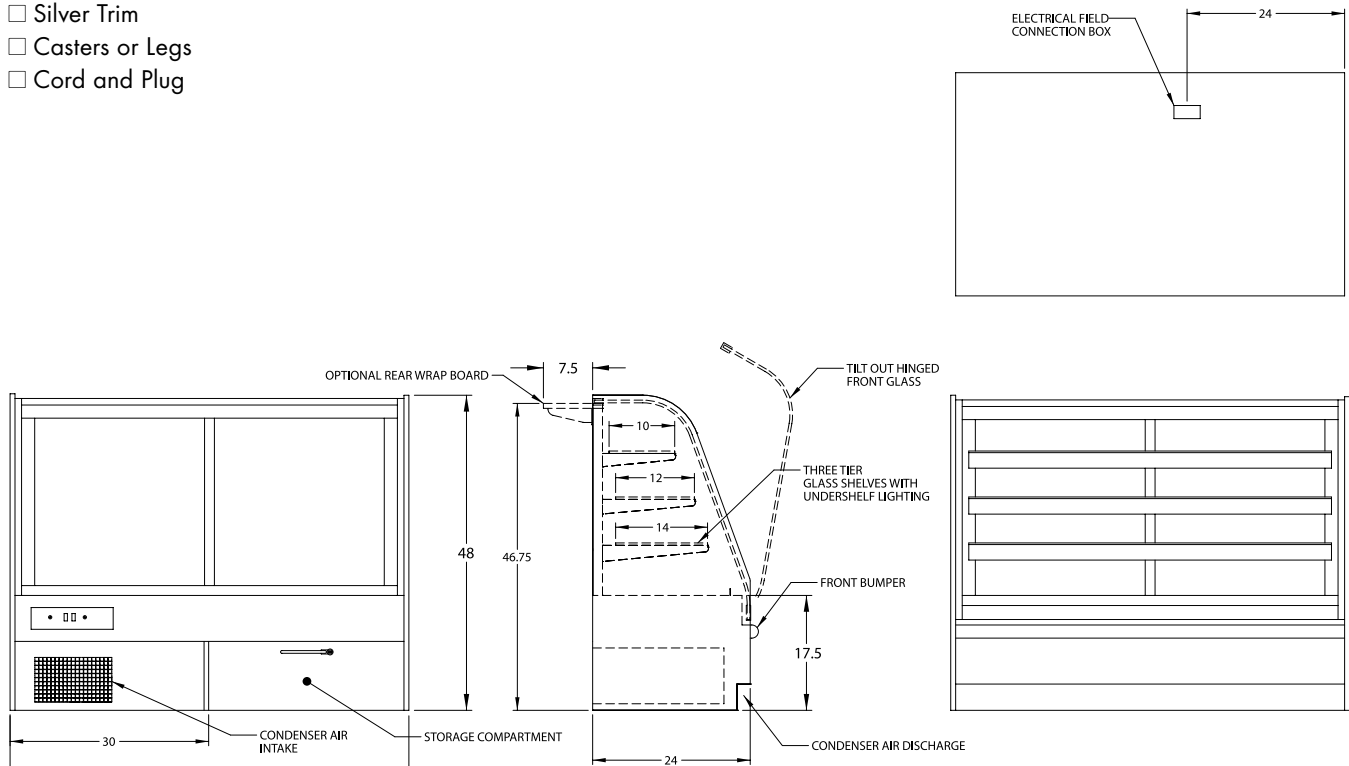

SPECIFICATIONS:

Model	Dimensions L W H	Shipping Weight (lbs.)	Max. Capacity Candy Trays	Power-120/60/1
Climate Controlled				
<input type="checkbox"/> FCCR-4	48" x 24" x 48"	635	16	9 AMPS
<input type="checkbox"/> FCCR-5	60 3/4" x 24" x 48"	750	28	9 AMPS
<input type="checkbox"/> FCCR-6	72" x 24" x 48"	850	32	10 AMPS
Non-Refrigerated				
<input type="checkbox"/> FCC-4	48" x 24" x 48"	585	16	2 AMPS
<input type="checkbox"/> FCC-5	60 3/4" x 24" x 48"	640	28	2 AMPS
<input type="checkbox"/> FCC-6	72" x 24" x 48"	695	32	2 AMPS

- Standard Tray Sizes: 7 x 8 x 1 1/4; 7 x 10 x 1 1/4; 7 x 14 x 1 1/4
- Due to continuing engineering improvements, specifications are subject to change without notice.



The Signature of Quality

FEDERAL INDUSTRIES
A Standex Company

215 FEDERAL AVENUE, BELLEVILLE, WISCONSIN 53508-9201

PHONE: 800-356-4206

EMAIL: geninfo@federalind.com

FAX: 608-424-3234

WEBSITE: www.federalind.com

