



GOLD MEDAL® PRODUCTS CO.

Fudge Cooker/Mixer

Model No. 2183-00-000

Specifications



**3" Minimum Clearance
between Kettle and Wall.**

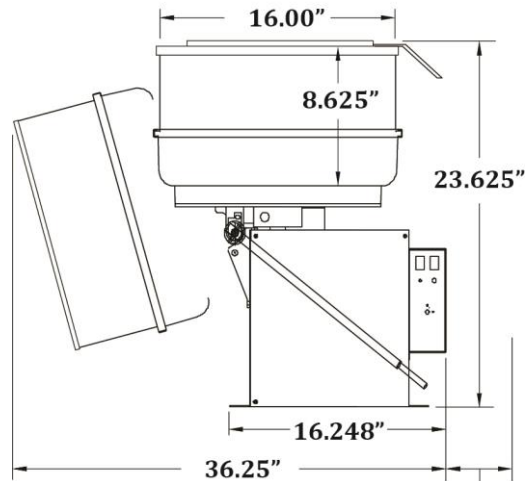

**6" Recommended Min. Clearance
between wall and Cntl Box for Service.**

General RH Unit shown above for dim. reference.

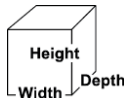

Overall Dimensions:

- Width:** 36.25"
- Depth:** 17.25"
- Height:** 23.625"

Reference drawing shown for additional dimensions and clearances required.

Electrical - Domestic

- 120V
- 1836 WATTS 60 Hz
- (NEMA 5-20P) Plug

Features:

- Uses 7 lbs. of dry fudge mix per batch; yeilds approximatly 8 lbs. of fudge
- Right Hand Dump
- Electronic Temperature Control with Digital Display
- Cast Aluminum Kettle with Stainless Steel Drum

Plug Type:



NEMA 5-20P

Agency Approvals:



LISTED



Gold Medal Products Co.
10700 Medallion Drive, Cincinnati, OH 45241

Ph: (513) 769-7676, (800) 543-0862; Fax: (513) 769-8500
gmpopcorn.com info@gmpopcorn.com