



**John  
BOOS**  
Since 1887

ITEM #: \_\_\_\_\_ QTY: \_\_\_\_\_  
MODEL #: \_\_\_\_\_  
PROJECT NAME: \_\_\_\_\_

111917

3601 S. Banker St. Effingham, IL 62401 • P.O. BOX 609 • Ph: (888) 431-2667 • Fax: (800) 433-2667

## **"180" ENCLOSED WORK TABLES - STAINLESS STEEL**

### **SLIDING DOOR STYLE W/ 5" REAR RISER, ELECTRICAL OUTLET CUTOUT, CUTTING BOARD STORAGE SLIDES**

#### **FEATURES:**

- 16 GAUGE STAINLESS STEEL TOP WITH 5" REAR RISER
- SLIDING DOOR STYLE
- TYPE 300 STAINLESS STEEL WITH # 4 POLISH, SATIN FINISH
- ELECTRICAL OUTLET CUT OUTS
- 3/4" THICK HIGH DENSITY POLY CUTTING BOARD & STORAGE RACK
- TOP IS SOUND DEADENED
- REINFORCED WITH 1"X2" CHANNEL RUNNING ENTIRE LENGTH OF TABLE
- 1-1/2" STALLION EDGE ON FRONT AND REAR WITH SIDE EDGES 90 DEGREE BEND DOWN FOR TABLE LINE-UP
- STAINLESS STEEL BASE AND UNDERSHELF
- UNDERSHELF IS SECURED IN A FIXED POSITION, 14-7/8" ABOVE FLOOR
- SHIPPED STANDARD WELDED SET-UP

#### **CONSTRUCTION:**

- TOP: STAINLESS STEEL TOPS ARE TIG WELDED, EXPOSED WELDS ARE POLISHED TO MATCH ADJACENT SURFACE.

#### **MATERIAL:**

- TOP: 16 GAUGE STAINLESS STEEL TYPE 300 STAINLESS STEEL WITH #4 POLISH, SATIN FINISH
- SHELF: 18 GAUGE TYPE 300 STAINLESS STEEL, #4 POLISH WITH SATIN FINISH
- LEGS: 1-1/2" SQUARE O.D., 16 GAUGE TUBULAR STAINLESS STEEL
- PANELS: 22 GAUGE TYPE 300 STAINLESS STEEL, #4 POLISH WITH SATIN FINISH
- FEET: 1" ADJUSTABLE STAINLESS STEEL BULLET FEET



STALLION EDGE

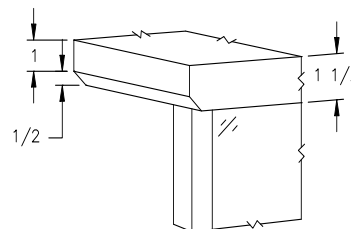

### **ENCLOSED WORK TABLES - STAINLESS STEEL**

24" WIDE	QTY	30" WIDE	QTY
180-31		180-36	
180-32		180-37	
180-33		180-38	
180-33A		180-38A	
180-34		180-39	
180-34A		180-39A	
180-35		180-40	

### **OPTIONAL ACCESSORIES**

DESCRIPTION	MODEL #	QTY
CASTERS		
OVERSHELVES		
POT RACKS		
INTERMEDIATE SHELVES		
S/S BUN PAN RACK		

## DETAILED SPECIFICATIONS

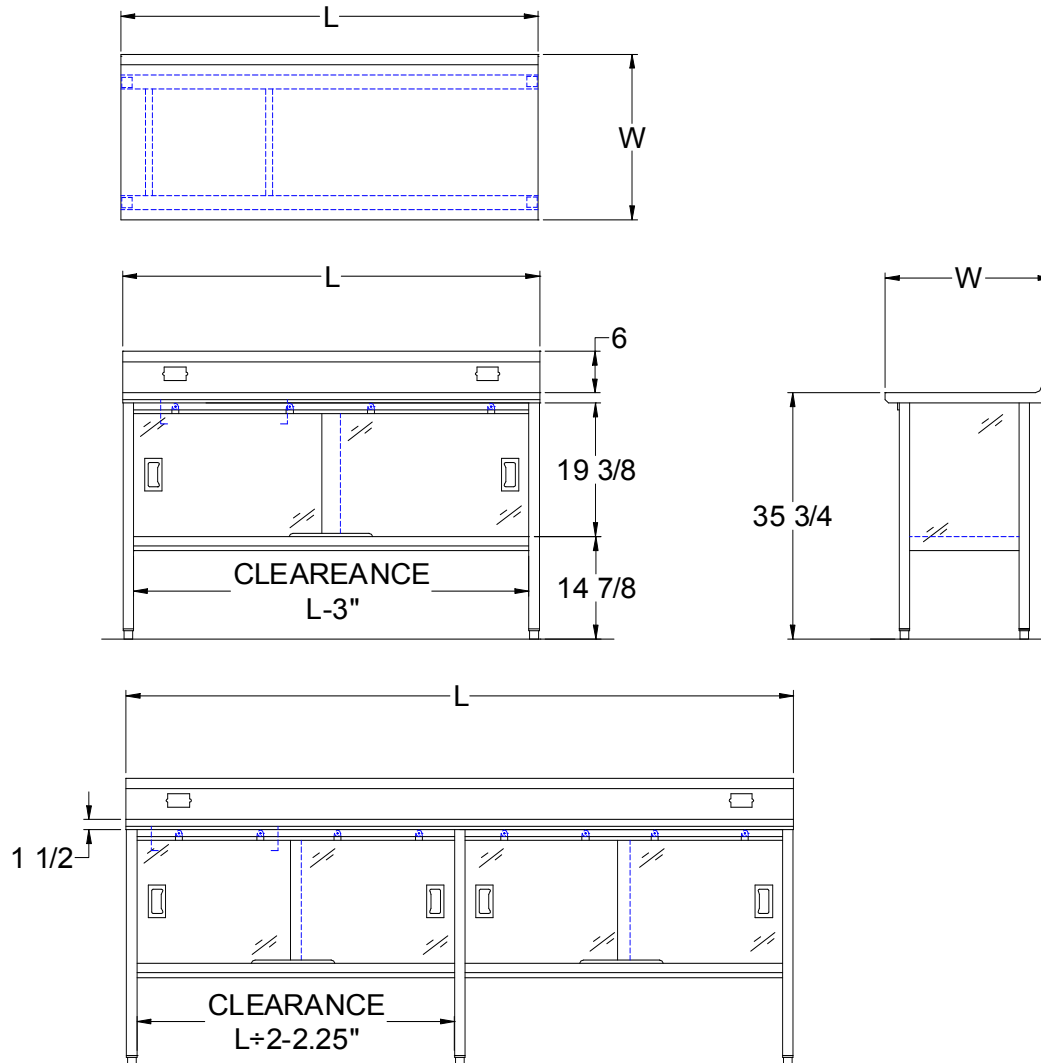

- UNITS 7 FT. AND LARGER ARE FURNISHED WITH SIX LEGS.
- FINISHED SIZE OF UNDERSHELF:  
SHELF LENGTH = LENGTH MINUS 4.875"  
SHELF WIDTH = WIDTH MINUS 4.25"

### ENCLOSED WORK TABLES - STAINLESS STEEL

LENGTH	24" WIDE	WT. (LBS)	30" WIDE	WT. (LBS)
48"	180-31	200	180-36	214
60"	180-32	228	180-37	246
72"	180-33	258	180-38	280
84"	180-33A	295	180-38A	319
96"	180-34	332	180-39	358
108"	180-34A	364	180-39A	391
120"	180-35	395	180-40	424

SOME UNITS SHIP UNASSEMBLED FOR REDUCED SHIPPING COST. ALL DIMENSIONS ARE TYPICAL. TOLERANCE +/- .500"  
John Boos & Co. is constantly engaged in a program of improving products and therefore reserves the right to change specifications without prior notice.



Boos  
locks

AQ AutoQuotes

3601 S. Banker St. • Effingham, IL 62401 • PO BOX 609 • quotes@johnboos.com

[www.johnboos.com](http://www.johnboos.com)

111917

355