



**John  
BOOS**  
Since 1887

ITEM #: \_\_\_\_\_ QTY: \_\_\_\_\_  
MODEL #: \_\_\_\_\_  
PROJECT NAME: \_\_\_\_\_

062217

3601 S. Banker St. Effingham, IL 62401 • P.O. BOX 609 • Ph: (888) 431-2667 • Fax: (800) 433-2667

## **"MS4-SSK" EQUIPMENT STANDS**

### **STAINLESS STEEL BASE**



#### **FEATURES:**

- 14GA TYPE 300 STAINLESS STEEL TOP WITH #4 POLISH, SATIN FINISH
- REINFORCED WITH A 1/2" CHANNEL RUNNING ENTIRE LENGTH OF TABLE
- SHELF ADJUSTABLE TO DESIRED HEIGHT
- ADJUSTABLE BULLET FEET
- SHIPPED KNOCKED-DOWN, EASY - TO - ASSEMBLE

#### **MATERIAL:**

- TOP: 14GA STAINLESS STEEL TYPE 300 STAINLESS STEEL WITH #4 POLISH, SATIN FINISH
- SHELF: 18GA STAINLESS STEEL
- GUSSETS: STAINLESS STEEL
- FEET: 1" ADJUSTABLE BULLET FEET

#### **CONSTRUCTION:**

- TOP: STAINLESS STEEL TOPS ARE TIG WELDED, EXPOSED WELDS ARE POLISHED TO MATCH ADJACENT SURFACE
- BASE: MIG WELDED STAINLESS FRAME



### **"MS4-SSK" 14GA EQUIPMENT STANDS W/ SHELF BASE**

24" WIDE	QTY	30" WIDE	QTY
MS4-2424SSK		MS4-3024SSK	
MS4-2430SSK		MS4-3030SSK	

## DETAILED SPECIFICATIONS

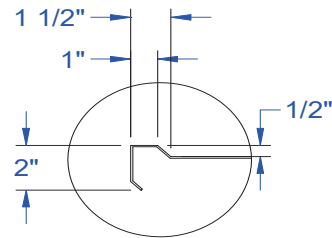
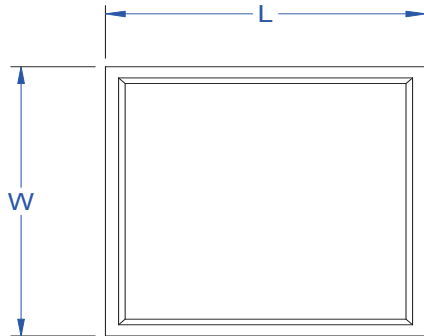

MARINE EDGE  
DETAIL

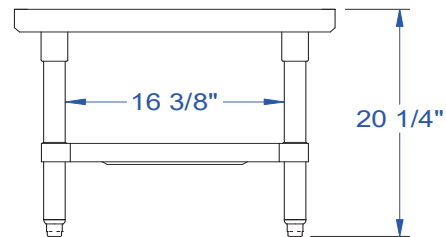
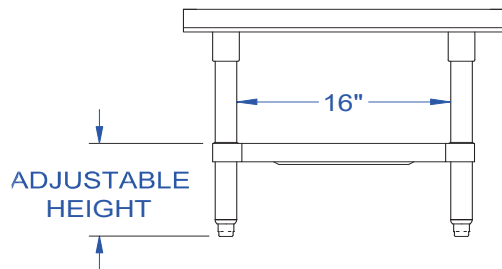

### **"MS4-SSK" 14GA EQUIPMENT STANDS W/ SHELF BASE**

LENGTH	24" WIDE	WT. (LBS)	30" WIDE	WT. (LBS)
15"	MS4-2415SSK	30	MS4-3015SSK	36
18"	MS4-2418SSK	36	MS4-3018SSK	40

SOME UNITS SHIP UNASSEMBLED FOR REDUCED SHIPPING COST. ALL DIMENSIONS ARE TYPICAL. TOLERANCE +/- .500"  
 John Boos & Co. is constantly engaged in a program of improving products and therefore reserves the right to change specifications without prior notice.



Boos  
locks

AQ AutoQuotes

3601 S. Banker St. • Effingham, IL 62401 • PO BOX 609 • [quotes@johnboos.com](mailto:quotes@johnboos.com)

[www.johnboos.com](http://www.johnboos.com)

062217

97