



Model: _____ Item #: _____ Date: _____
 Project: _____ Qty: _____ Approved By: _____

Speed Multi-Stations

ROYAL SERIES



Photo shown with modular bar die. Wood top by others.

Standard Features

- Removable garnish station with integrated cover
- Insulated elixir bottle well
- Adjustable ice bin dividers which allow for storage of different types of ice
- All multi-stations 24" front-to-back
- Available on stainless legs or modular bar die
- 12" deep ice bin and insulated bin come with 1" drain (model 23-111), 1/2" drain (model 23-110) on ice bins with cold plates
- Built-in Speed Rail
- Elixir bottles not included, recommended with Tablecraft 916 (16 oz.) or 9805 (8.5 oz) olive oil bottles
- Ships as a complete station

Specifications

Materials	<ul style="list-style-type: none"> ▪ Interior: 20 gauge stainless steel. 12" deep ice bin section. 10" deep bottle section ▪ Front Apron: 20 gauge stainless steel clad over 20 gauge galvanized steel ▪ Sides: 20 gauge stainless steel ▪ Backsplash: 20 gauge stainless steel ▪ Back & Bottom: 20 gauge galvanized steel 	Tubing Access (Cold Plate)	<ul style="list-style-type: none"> ▪ 3/4" x 3-1/2" cutout in left side of backsplash
	Drains & Plumbing	<ul style="list-style-type: none"> ▪ 1" NPS Drain, Elixer section ▪ 1" IPS Drain, Ice bin ▪ 1/2" IPS Drain, Ice bin with Cold Plate. 4" PVC tailpiece provided. PVC tailpiece required to avoid condensation through metal to metal contact. 	Insulation
Cold Plate		<ul style="list-style-type: none"> ▪ Cast aluminum post mix plate with 7 or 10 circuits depending on model. Plate is sealed into bottom. Each circuit is 5/16" OD stainless steel tubing. Two full with remainder to be half circuits. Bump and swedge fittings on ends. 	Backsplash
			Legs

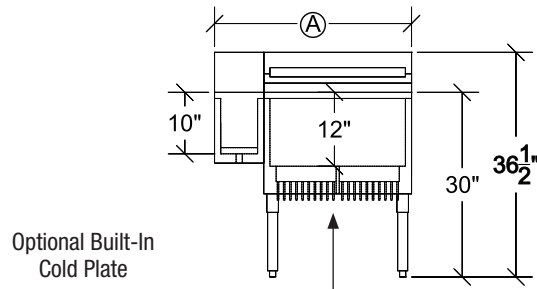
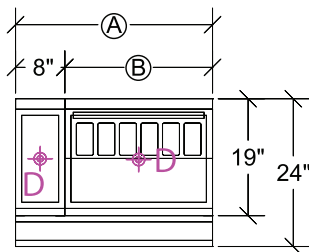
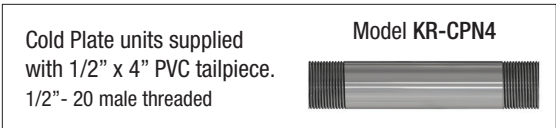

8" Elixir Mixology Multi-Stations

Model	Model with Cold Plate	Overall Size (A)	Ice Bin Size (B)	Ice Bin Location	Ice Capacity	Garnish Cups	Elixir Bottles	Liquor Bottles	Ice Bin Dividers	Weight (without Cold Plate)	Weight (with Cold Plate)
KR24-MS26R	KR24-MS26R-7	26"	18"	Right	63	5	10	7	0	117	151
KR24-MS26L	KR24-MS26L-7	26"	18"	Left	63	5	10	7	0	117	151
KR24-MS34C	KR24-MS34C-7	34"	18"	Center	63	5	20	9	0	163	198
KR24-MS32R	KR24-MS32R-10	32"	24"	Right	80	6	10	9	1	123	218
KR24-MS32L	KR24-MS32L-10	32"	24"	Left	80	6	10	9	1	123	218
KR24-MS40C	KR24-MS40C-10	40"	24"	Center	80	6	20	11	1	169	264
KR24-MS38R	KR24-MS38R-10	38"	30"	Right	97	8	10	10	2	138	233
KR24-MS38L	KR24-MS38L-10	38"	30"	Left	97	8	10	10	2	138	233
KR24-MS46C	KR24-MS46C-10	46"	30"	Center	97	8	20	13	2	184	279