



NOR-LAKE, INCORPORATED
727 Second Street
Hudson, Wisconsin 54016

800-955-5253
715-386-2323
866-961-5253 Parts
800-388-5253 Service
715-386-6149 FAX
www.norlake.com

ADVANTEDGE™ SHALLOW SOLID DOOR BACK BAR REFRIGERATORS



PROJECT:

ITEM NUMBER:

MODEL NUMBER:

SOLID DOOR BACK BAR REFRIGERATORS

SPECIFICATIONS FOR: NLBB48N, NLBB60N, NLBB72N

- **Finish:** Heavy duty stainless steel top and black vinyl coated steel exterior front, sides and back. Galvanized steel interior walls with stainless steel floor.
- **Insulation:** Foamed-in-place 1-1/2" CFC-free polyurethane insulation
- **Hardware:** Solid doors with locks, magnetic door gaskets, plastic breaker strips around door openings to limit the formation of any condensation. Two adjustable epoxy coated shelves per door section standard. Interior LED light.
- **Electrical:** 115 volt, 60 Hz, 1 phase with cord and NEMA 5-15P plug
- **Refrigeration:** Self-contained forced air R-134a capillary tube refrigeration system. Temperature range from +34°F to +38°F. Adjustable temperature control.
- **Approvals:** ETL Sanitation listed, UL, C-UL Safety listed, approved to NSF standard for packaged food products **

STANDARD FEATURES

- Adjustable temperature control
- Black vinyl coated steel front, sides and back exterior
- Epoxy coated flat shelves with clips
- Free flowing air system at all times to ensure uniformly cooled product
- LED interior light
- Slide out condensing unit
- Temperature range: +34°F to +38°F
- ETL Sanitation listed, UL, C-UL Safety listed, approved to NSF standard for pre-packaged food products **
- Warranties: 3 year parts & labor, 5 year compressor

OPTIONAL FEATURES*

- 4" casters
- Floor rack(s)
- Glass door(s)
- Shelves with product guides

*Most options are available one week from receipt of order. Please contact us for specific questions.

** C-UL is Underwriters Laboratories Safety Certification Mark which indicates that UL has tested the equipment to applicable CSA Standards.

** UL Sanitation is Underwriters Laboratories Sanitation Mark which indicates that UL has tested the equipment to applicable NSF Standards.

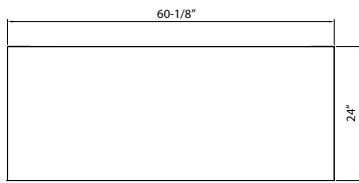

**TOP
NLBB60N**

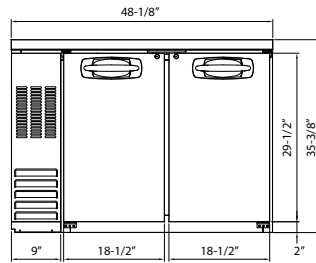

**FRONT
NLBB48N**

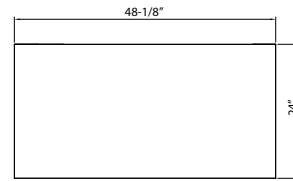

**TOP
NLBB48N**

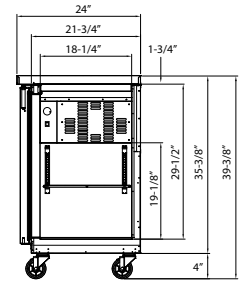

**SIDE
ALL MODELS**

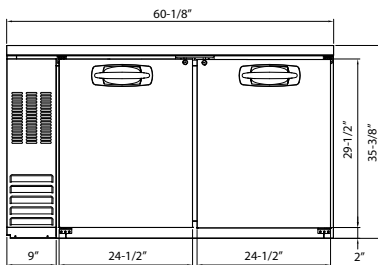

**FRONT
NLBB60N**

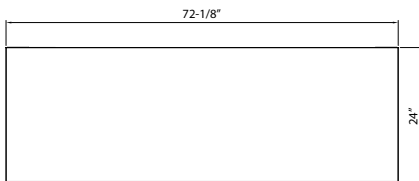

**TOP
NLBB72N**

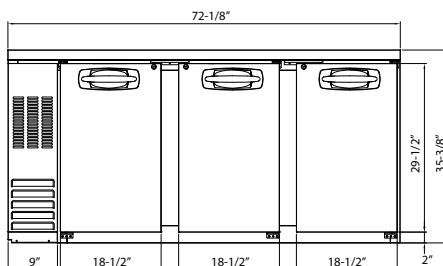

**FRONT
NLBB72N**

SPECIFICATIONS

Models	NLBB48N	NLBB60N	NLBB72N
<i>Crated Weight (lbs) (kg)</i>	198 (90)	276 (125)	320 (145)
<i>Crated Height (in) (cm)</i>	43-1/4 (110)	43-1/4 (110)	43-1/4 (110)
<i>Crated Width (in) (cm)</i>	51-3/4 (131)	63-3/4 (162)	75-3/4 (192)
<i>Crated Depth (in) (cm)</i>	28-1/2 (72)	28-1/2 (72)	28-1/2 (72)
<i>Interior Height (in) (cm)</i>	30-7/8 (77)	30-7/8 (77)	30-7/8 (77)
<i>Interior Width (in) (cm)</i>	35-1/4 (90)	47-1/4 (120)	59-1/4 (151)
<i>Interior Depth (in) (cm)</i>	18-1/4 (46)	18-1/4 (46)	18-1/4 (46)
<i>Overall Height (in) (cm)</i>	35-3/8 (90)	35-3/8 (90)	35-3/8 (90)
<i>Overall Width (in) (cm)</i>	48-1/8 (122)	60-1/8 (153)	72-1/8 (183)
<i>Overall Depth (in) (cm)</i>	26 (66)	26 (66)	26 (66)
<i>Gross Cubage (CuFt) (L)</i>	11.6 (328.5)	15.6 (442)	19.6 (555)
<i>Number of Shelves</i>	4	4	6
<i>Shelf Area (SqFt) (Sqm)</i>	8.5 (0.8)	11.18 (1.03)	14.1 (1.3)
<i>Condensing Unit Size</i>	3/8 HP	3/8 HP	3/8 HP
<i>Refrigerant</i>	R-134a	R-134a	R-134a
<i>Electrical Characteristics</i>	115/60/1	115/60/1	115/60/1
<i>Cord and Plug Furnished</i>	Yes	Yes	Yes
<i>NEMA Plug Configuration</i>	5-15P	5-15P	5-15P
<i>Total Amp Draw</i>	6.3	6.3	6.3
<i>12 oz. Can Capacity</i>	714	966	1218
<i>12 oz. Bottle Capacity</i>	336	468	588

Specifications subject to change without notice.



Revision Date: 4/18
Part Number: 157999